



## QUICK REFERENCE GUIDE

### Recommended Testing Environment

- Conduct the test in an area with little to no noise and distraction
- Provide a comfortable patient chair and a small table

### 1. Turning on the AdaptDx Pro<sup>®</sup>

- Press the button on the handheld controller to activate the battery
- Press the power button on the left-hand side below the LCD Screen

### 2. Setting the AdaptDx Pro up for testing

- The Home Screen displays the default settings for testing
- Use the five-way button on the handheld controller to navigate the screen, then select the blue button with the white arrow to proceed to test
- To change the default settings, select the "System Tools" icon at the top left-hand side of the LCD screen. Left and right arrows will appear so the desired selections can be made. To save and proceed with the test, click the blue button with the white arrow.

### CONTROLLER INDICATOR LIGHTS

#### Solid Green = Full Power

Controller ready for use

#### Flashing Green = Low Power

Enough power for one test

#### Flashing Amber = Very Low Power

Not enough power to test

### HOME SCREEN

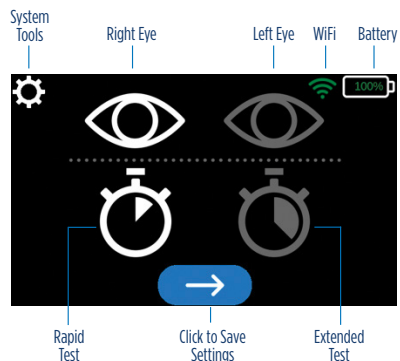

### 3. Patient preparation and focus adjustment

- Once test set-up has been completed, an animation will provide step-by-step instructions on the LCD screen. This will demonstrate how to fit the headset on the patient and how the focus adjustment works.

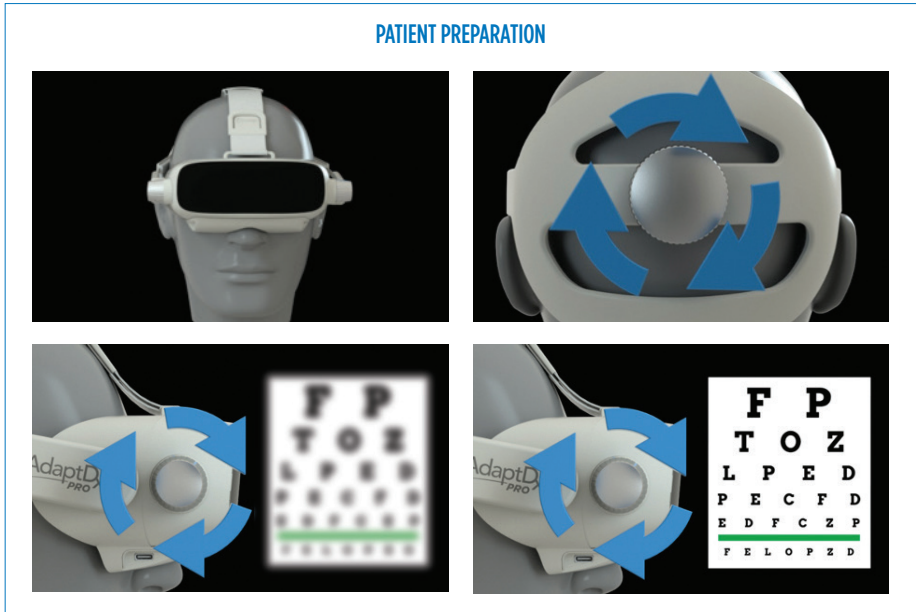

### 4. Test progression

- Theia™, the on-board technician, will introduce herself to the patient and outline the basics of the test which will include:
  - Introduction with Pupil Size and Fixation
  - Bleach Demonstration
  - Stimulus Demonstration
  - Test Administration

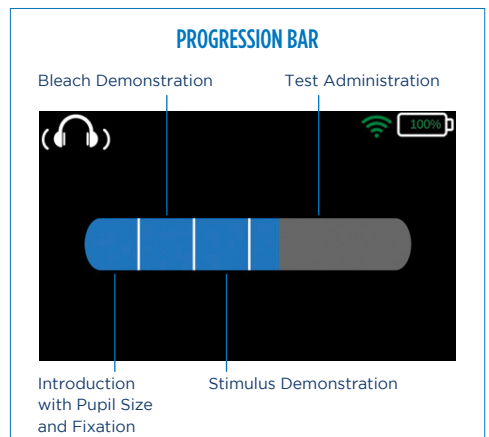

## 5. Results review

- The Rod Intercept® (RI®) is the time in minutes at which dark adaptation recovery is complete
- The fixation error is the percentage of time the patient generates invalid thresholds
- An invalid test will generate if:
  - The patient blinks or averts their gaze during the photobleaching
  - The fixation rate is 30% or higher
- If an invalid test is generated, the patient's other eye can be tested immediately or you can wait at least 30 minutes to retest the same eye

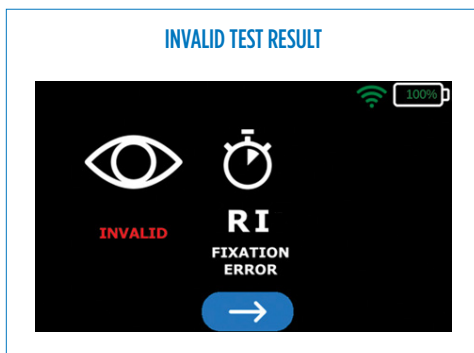
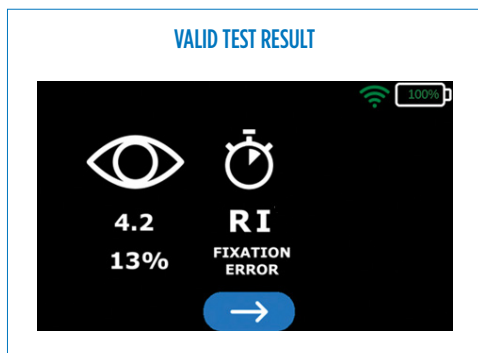

## 6. Deleting test results

- Test results should always be properly recorded once the test is completed
  - Results to be recorded include eye tested (OS or OD), test protocol (Rapid or Extended), Rod Intercept and Fixation Error Rate
  - Once a test is deleted, the test can no longer be retrieved
- Select the blue button with the white arrow for the delete test screen
- Select the icon to delete test. The test must be deleted before proceeding to another test.

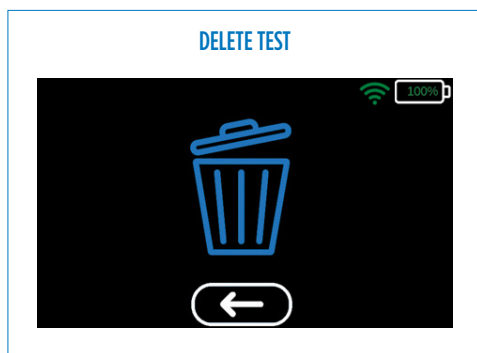

## Cleaning

- Never immerse, spray, pour or spill any liquids on the AdaptDx Pro
- Recommended cleaning includes regular swabbing of the patient contact points:
  - Conforming Eyecups
  - Padded Liner
  - Adjustable Headstrap
  - Handheld Controller
  - Controller Cable
- The use of isopropyl wipes is recommended for cleaning
- View windows should be gently cleaned with a lens cloth and/or compressed air

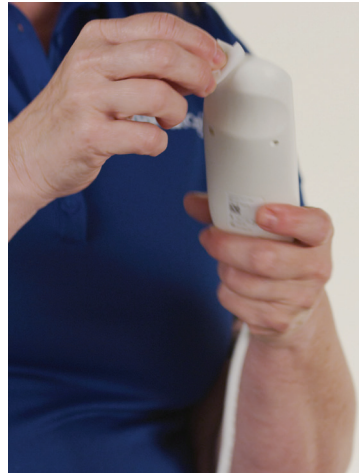

## Contact Information

For customer support, contact MacuLogix at **1.888.392.6801**

To order replacement parts, visit [store.maculogix.com](https://store.maculogix.com) or contact Customer Support at **1.888.392.6801**